



COMPONENTI Ex-de COMPONENTS Ex-de

ADV0201 Explosion-proof switch module

Ex mark: Ex II2G Ex de IIC

Intended use: Can be used in zone 1 and zone 2

Ambient temperature use: $-55^{\circ}\text{C} \leq T_a \leq 60^{\circ}\text{C}$

Degree of protection: IP20

Rated voltage:	250V	250V	110V	24V
Regimentation use:	AC12	AC15	DC13	DC13
Rated current:	16A	10A	0.5A	1A
Ambient temperature:	$T_a \leq 40^{\circ}\text{C}$	$T_a \leq 60^{\circ}\text{C}$	$T_a \leq 60^{\circ}\text{C}$	$T_a \leq 60^{\circ}\text{C}$

Mechanical life: 100,000 times

Board front type mounting: May be held on mounting rails

TS35 7.5 or with screws

Board back type mounting: On 1-6mm panel

Meet the standard: IEC60079 EN60079

P□/K□/L□/...Series operation head

Ex mark: Ex II2GD Ex eII Ex tD A21

Intended use: Can be used in zone 1 and zone 2

Can be used in zone 21 and zone 22

Ambient temperature use: $-40^{\circ}\text{C} \leq T_a \leq 55^{\circ}\text{C}$

Degree of protection: IP66

Material: polyamide

Meet the standard: IEC60079 IEC61241 EN60079 EN61241

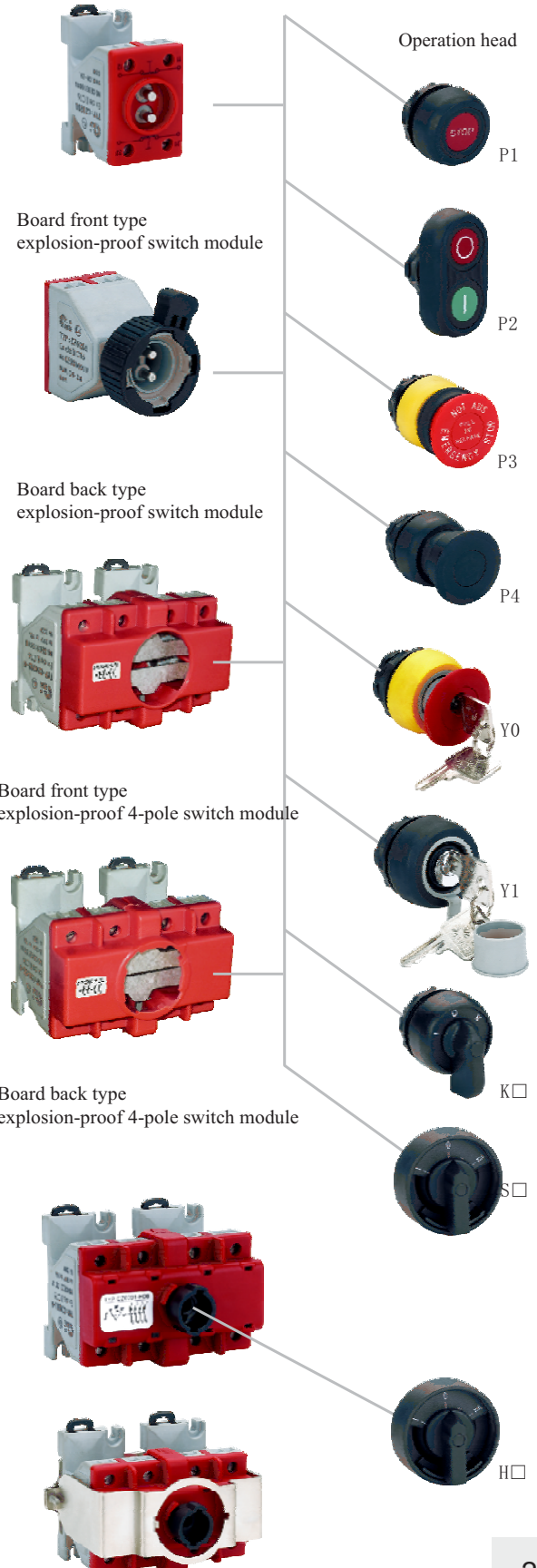



COMPONENTI Ex-de COMPONENTS Ex-de

• Order specifications:

Illustration	Construction type	Type	Button contact	Order No.(Code)		
	Board front type	P1 Rubber sheath button	1NC/1NO	0201-60-P1□□		
			2NC	0201-61-P1□□		
			2NO	0201-62-P1□□		
			Board back type	P1 Rubber sheath button	1NC/1NO	0201-70-P1□□
					2NC	0201-71-P1□□
					2NO	0201-72-P1□□
	Board front type	P2 Rubber sheath double button	1NC/1NO	0201-60-P2□□□□		
			2NC	0201-61-P2□□□□		
			2NO	0201-62-P2□□□□		
			Board back type	P2 Rubber sheath double button	1NC/1NO	0201-70-P2□□□□
					2NC	0201-71-P2□□□□
					2NO	0201-72-P2□□□□

• Label:





Code	Engraved words in the label	Colour of label	Colour of engraved words
01	Blank	Green	
02	I	Green	white
03	ON	Green	white
04	START	Green	white
21	Blank	red	
22	O	red	white
23	OFF	red	white
24	STOP	red	white
41	Blank	white	
42	II	white	black
43	↑	white	black
44	Start	white	black
45	Stop	white	red
46	IE FW	white	black
47	BW	white	black
48	Stop	white	red
49	↑ ↑	white	black
61	Blank	yellow	
62	II	yellow	white
81	Blank	black	



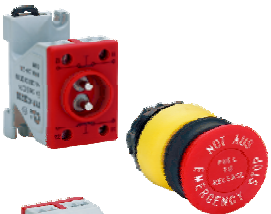

COMPONENTI Ex-de COMPONENTS Ex-de

- Order specifications:

Illustration	Construction type	Type	Button contact	Order No.(Code)
	Board front type	P3 Emergency self-locking button	$\begin{matrix} 11 & 23 \\ & \\ \vdots & \vdots \\ 12 & 24 \end{matrix}$ 1NC/1NO	0201-60-P3
			$\begin{matrix} 11 & 21 \\ & \\ \vdots & \vdots \\ 12 & 22 \end{matrix}$ 2NC	0201-61-P3
			$\begin{matrix} 13 & 23 \\ & \\ \vdots & \vdots \\ 14 & 24 \end{matrix}$ 2NO	0201-62-P3
	Board back type		$\begin{matrix} 11 & 23 \\ & \\ \vdots & \vdots \\ 12 & 24 \end{matrix}$ 1NC/1NO	0201-70-P3
			$\begin{matrix} 11 & 21 \\ & \\ \vdots & \vdots \\ 12 & 22 \end{matrix}$ 2NC	0201-71-P3
			$\begin{matrix} 13 & 23 \\ & \\ \vdots & \vdots \\ 14 & 24 \end{matrix}$ 2NO	0201-72-P3
	Board front type	P4 Black mushroom head button	$\begin{matrix} 11 & 23 \\ & \\ \vdots & \vdots \\ 12 & 24 \end{matrix}$ 1NC/1NO	0201-60-P4
			$\begin{matrix} 11 & 21 \\ & \\ \vdots & \vdots \\ 12 & 22 \end{matrix}$ 2NC	0201-61-P4
			$\begin{matrix} 13 & 23 \\ & \\ \vdots & \vdots \\ 14 & 24 \end{matrix}$ 2NO	0201-62-P4
	Board back type		$\begin{matrix} 11 & 23 \\ & \\ \vdots & \vdots \\ 12 & 24 \end{matrix}$ 1NC/1NO	0201-70-P4
			$\begin{matrix} 11 & 21 \\ & \\ \vdots & \vdots \\ 12 & 22 \end{matrix}$ 2NC	0201-71-P4
			$\begin{matrix} 13 & 23 \\ & \\ \vdots & \vdots \\ 14 & 24 \end{matrix}$ 2NO	0201-72-P4
	Board front type	Y0 Red mushroom button with key	$\begin{matrix} 11 & 23 \\ & \\ \vdots & \vdots \\ 12 & 24 \end{matrix}$ 1NC/1NO	0201-60-Y0
			$\begin{matrix} 11 & 21 \\ & \\ \vdots & \vdots \\ 12 & 22 \end{matrix}$ 2NC	0201-61-Y0
			$\begin{matrix} 13 & 23 \\ & \\ \vdots & \vdots \\ 14 & 24 \end{matrix}$ 2NO	0201-62-Y0
	Board back type		$\begin{matrix} 11 & 23 \\ & \\ \vdots & \vdots \\ 12 & 24 \end{matrix}$ 1NC/1NO	0201-70-Y0
			$\begin{matrix} 11 & 21 \\ & \\ \vdots & \vdots \\ 12 & 22 \end{matrix}$ 2NC	0201-71-Y0
			$\begin{matrix} 13 & 23 \\ & \\ \vdots & \vdots \\ 14 & 24 \end{matrix}$ 2NO	0201-72-Y0
	Board front type	Y1 Button with key	$\begin{matrix} 11 & 23 \\ & \\ \vdots & \vdots \\ 12 & 24 \end{matrix}$ 1NC/1NO	0201-60-Y1
			$\begin{matrix} 11 & 21 \\ & \\ \vdots & \vdots \\ 12 & 22 \end{matrix}$ 2NC	0201-61-Y1
			$\begin{matrix} 13 & 23 \\ & \\ \vdots & \vdots \\ 14 & 24 \end{matrix}$ 2NO	0201-62-Y1
	Board back type		$\begin{matrix} 11 & 23 \\ & \\ \vdots & \vdots \\ 12 & 24 \end{matrix}$ 1NC/1NO	0201-70-Y1
			$\begin{matrix} 11 & 21 \\ & \\ \vdots & \vdots \\ 12 & 22 \end{matrix}$ 2NC	0201-71-Y1
			$\begin{matrix} 13 & 23 \\ & \\ \vdots & \vdots \\ 14 & 24 \end{matrix}$ 2NO	0201-72-Y1



COMPONENTI Ex-de COMPONENTS Ex-de

- Outline dimensions:

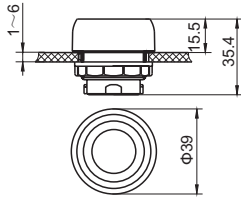

P1 Operation head of rubber sheath button

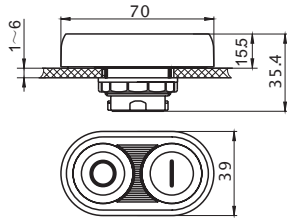

P2 Operation head of rubber sheath double button

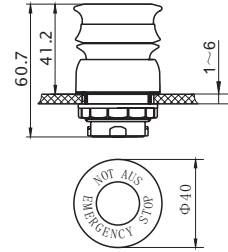

P3 Operation head of emergency self-locking button

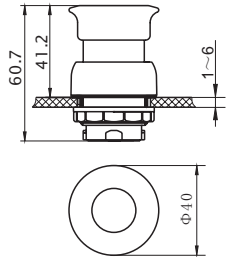

P4 Operation head of black mushroom head button

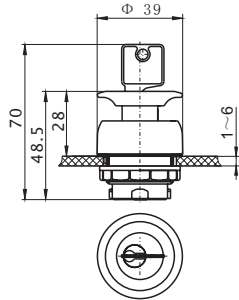

Y0 Operation head of red mushroom button with key

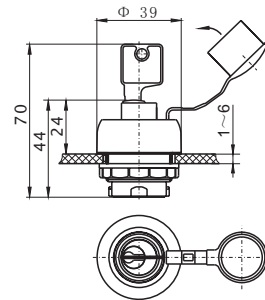

Y1 Operation head of button with key

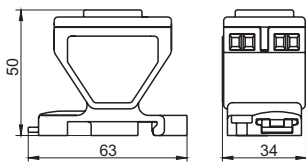

ADV0201 Broad front type explosion-proof switch module

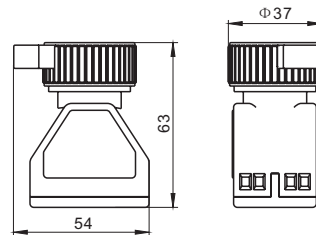

ADV0201 Board back type explosion-proof switch module

- Mounting pitches:

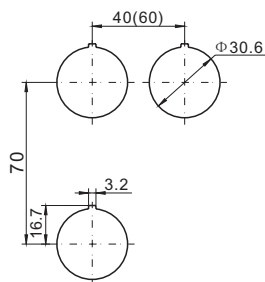

-

Outline dimensions of board back type with operation head

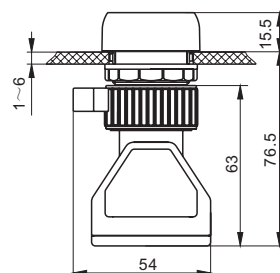



COMPONENTI Ex-de COMPONENTS Ex-de

ADV0202 series, Signal Lamp

Ex mark: $\text{Ex II 2G Ex de IIC}$

Intended use: Can be used in zone 1 and zone 2

Ambient temperature use: $-55^{\circ}\text{C} \leq \text{Ta} \leq 60^{\circ}\text{C}$

Degree of protection: IP20

Rated voltage: AC24-240V DC24-36V

Power consumption: $P_{\text{max}} \leq 1\text{W}$

Light source: LED

Electric life: One hundred thousand hours

Board front type mounting: May be held on mounting rails

TS35 7.5 or with screws

Board back type mounting: On 1-6mm panel

Meet the standard: IEC60079 EN60079



Board front type



Board back type

Colour of bezel	The voltage of signal lamp module	Colour or lamp head	Order No.(Code)
Red Green Yellow Blue White	AC24V - 240V DC24V - 36V	Red Green Yellow Blue White	0202-□R1-LR 0202-□G1-LG 0202-□Y1-LY 0202-□B1-LB 0202-□W1-LW

6 — Board front type

7 — Board back type

Outline dimensions:

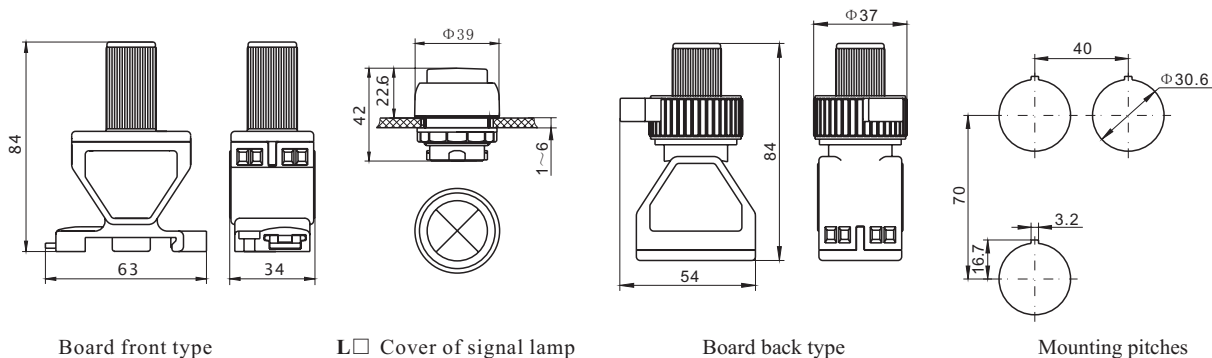



COMPONENTI Ex-de COMPONENTS Ex-de

ADV0212 series, Signal Lamp with Button

Ex mark: Ex de IIC

Intended use: Can be used in zone 1 and zone 2

Ambient temperature use: $-55^{\circ}\text{C} \leq \text{Ta} \leq 60^{\circ}\text{C}$

Degree of protection: IP20

Button: Conventional closed heating current: 10A

Rated voltage: 250V 24V

Regimentation use: AC15 DC13

Rated current: 6A 1A

Mechanical life: 300,000 times

Signal lamp : Light source: LED Power consumption: $P_{\text{max}} \leq 1\text{W}$

Rated voltage: AC24-240V DC24-36V

Electric life: One hundred thousand hours

Board front type mounting: May be held on mounting rails

TS35 7.5 or with screws

Board back type mounting: On 1-6mm panel



Board front type



Board back type

Colour of operation head	Button contact / the voltage of signal lamp	Colour of lamp head	Order No.(Code)
Red		Red	0212-□3R1-PR
Green		Green	0212-□3G1-PG
Yellow		Yellow	0212-□3Y1-PY
Blue		Blue	0212-□3B1-PB
White		White	0212-□3W1-PW
Red		Red	0212-□4R1-PR
Green		Green	0212-□4G1-PG
Yellow		Yellow	0212-□4Y1-PY
Blue		Blue	0212-□4B1-PB
White		White	0212-□4W1-PW

6 — Board front type
7 — Board back type

Outline dimensions:

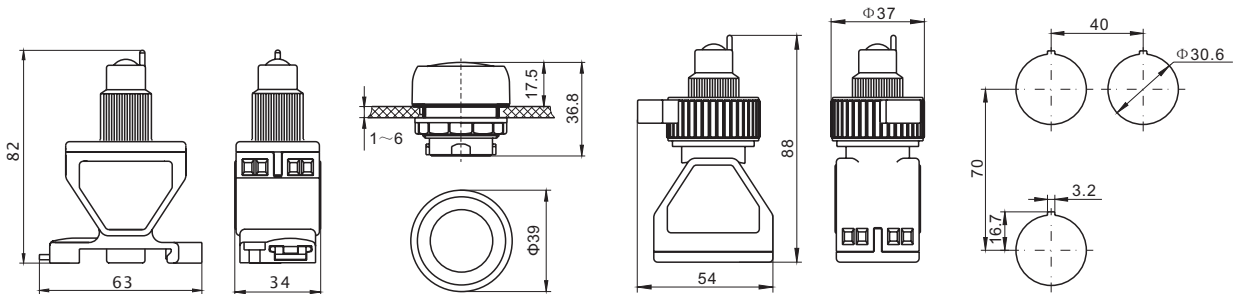

Board front type

□ Operation head of signal lamp with button

Board back type

Mounting pitches



COMPONENTI Ex-de COMPONENTS Ex-de

P□/K□/L□/...Series operation head

Ex mark: ⓂI2GD Ex eII Ex tDA21

Intended use: Can be used in zone 1 and zone 2

Can be used in zone 21 and zone 22

Ambient temperature use: $-40^{\circ}\text{C} \leq \text{Ta} \leq 55^{\circ}\text{C}$

Degree of protection: IP66

Material: Polyamide







Meet the standard: IEC60079 EN60079 IEC61241 EN61241

Conformity to: CE 0722

	Description	Direction of Anchor Point	Order No.
P1	Operation head of rubber sheath button With including label "0, I, START, STOP".		P1
	Operation head of rubber sheath double button With including label "0, I, START, STOP".		P2
P2	Operation head of emergency self-locking button With engraved letters "NOT AUS EMERGENCY STOP"		P3
	Operation head of black mushroom head button		P4
P3	Operation head of red mushroom button with key Press by hand, the key releases		Y02
P4	Operation head of button with key May lock in the initial position; May take out the key in the initial position		Y12
	Operation head of switch 	0 Self-reset, II Self-reset	
			K42 S42
0 Self-lock, II Self-lock			K51 S51
			K52 S52
0 + I Self-lock			K61 S61
			K62 S62
0 Self-lock, I Self-reset			K81 S81
			K82 S82
K□	Operation head of 4-pole switch		H11
			H12
S□ H□	L Signal lamp Red Green Yellow Blue White		LR LG LY LB LW
L□	Operation head of signal lamp with button Red Green Yellow Blue White		PR PG PY PB PW
P□			



COMPONENTI Ex-de COMPONENTS Ex-de

	Description	Direction of Anchor Point	Order No.
DW □ 	Operation head of potentiometer setting		DW1
			DW2
B1 	Stopping plug: Seal the unused aperture on the front panel.		B1
EXM 	Calotte: Protective window for measuring meter		EXM

ADV0201 Series explosion-proof switch module

Explosion-proof 2-pole switch module



Switch contact	Order No.
1NC/1NO	0201-□0
2NC	0201-□1
2NO	0201-□2
6 - Board front type	
7 - Board back type	
9 - Board back unit type	

Explosion-proof 4-pole switch module

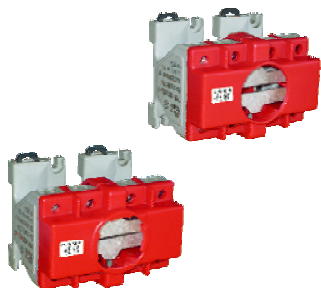

Switch contact	Order No.
2NC/2NO	0201-□50
4NC	0201-□51
4NO	0201-□52
1NC/3NO	0201-□53
3NC/1NO	0201-□54
6 - Board front type	
7 - Board back type	

Explosion-proof 4-pole switch module



Contact schematic for operating position	Order No.
See page A / 27 contact schematic	0201-H□ □□□□
6 - Board front type	
7 - Board back type	
Code of switch contact schematic	



COMPONENTI Ex-de COMPONENTS Ex-de

ADV0205 series, Ammeter

Ex mark: Ex II 2G Ex ell

Intended use: Can be used in zone 1 and zone 2

Ambient temperature use: $-40^{\circ}\text{C} \leq T_a \leq 60^{\circ}\text{C}$

Ammeter framework: Electromagnetic

Accuracy class: 1.5

Overload scale: 2 times, 5 times

Board front type mounting: May be held on mounting rails

TS35 7.5 or with screws

Board back type mounting: On 1-6mm panel

Meet the standard: IEC60079 EN60079

Conformity to: CE 0575



Board front type



Board back type



EXM Calotte

Calotte	Measuring way	Overload scale	Measuring range	Order No.(Code)
EXM		2	0-1 / 2A 0-4 / 8A 0-5 / 10A 0-10 / 20A 0-15 / 30A	M□DA 1 M□DA 4 M□DA 5 M□DA 10 M□DA 15
		2	0-1 / 2A 0-2.5 / 5A 0-5 / 10A 0-15 / 30A 0-25 / 50A 0-40 / 80A 0-50 / 100A 0-60 / 120A 0-75 / 150A 0-100 / 200A 0-150 / 300A 0-200 / 400A 0-250 / 500A 0-300 / 600A 0-400 / 800A 0-500 / 1000A 0-600 / 1200A	M□WA 01 / □-2 M□WA 2.5 / □-2 M□WA 5 / □-2 M□WA 15 / □-2 M□WA 25 / □-2 M□WA 40 / □-2 M□WA 50 / □-2 M□WA 60 / □-2 M□WA 75 / □-2 M□WA 100 / □-2 M□WA 150 / □-2 M□WA 200 / □-2 M□WA 250 / □-2 M□WA 300 / □-2 M□WA 400 / □-2 M□WA 500 / □-2 M□WA 600 / □-2
		5	0-1 / 5A 0-2.5 / 12.5A 0-5 / 25A 0-15 / 75A 0-25 / 125A 0-40 / 200A 0-50 / 250A 0-60 / 300A 0-75 / 375A 0-100 / 500A 0-150 / 750A 0-200 / 1000A 0-250 / 1250A 0-300 / 1500A 0-400 / 2000A 0-500 / 2500A 0-600 / 3000A	M□WA 01 / □-5 M□WA 2.5 / □-5 M□WA 5 / □-5 M□WA 15 / □-5 M□WA 25 / □-5 M□WA 40 / □-5 M□WA 50 / □-5 M□WA 60 / □-5 M□WA 75 / □-5 M□WA 100 / □-5 M□WA 150 / □-5 M□WA 200 / □-5 M□WA 250 / □-5 M□WA 300 / □-5 M□WA 400 / □-5 M□WA 500 / □-5 M□WA 600 / □-5

6 — Board front type

7 — Board back type

Connect to the secondary current transformer

5A	5
1A	1