



## SCATOLE DI DERIVAZIONE IN ACCIAIO A SICUREZZA AUMENTATA "Ex-e" "Ex-e" STAINLESS STEEL INCREASED SAFETY JUNCTION BOXES SERIE - SERIES "CSX"

MODO DI PROTEZIONE - PROTECTION MODE:

II 2 G Ex e IIC T6 Gb or II 2 G Ex e IIC T5 Gb or II 2 G Ex ia IIC T6 Gb or II 2 G Ex e ia IIC T6 Gb  
**For DUST**

II 2 D Ex tb IIIC T85°C Db IP66 or II 2 D Ex tb IIIC T100°C Db IP66 or II 2 D Ex tb ia IIIC T85°C Db Ip66

(Amb.temperature -40°C to +55°C; -20°C for "ia" version)

CERTIFICATO - CERTIFICATE: ATEX, IECEx, GOST-R

Queste scatole della serie "CSX" sono utilizzate in ambienti a sicurezza aumentata "Ex-e" Zona 1,2,21,22, sono destinate ad essere utilizzate con morsetti per la distribuzione. Sono realizzate in lamiera inox AISI316L piegata e saldata, possono essere realizzate con o senza flangie asportabili (sui 4 lati, a richiesta è possibile realizzarle su uno o più lati a scelta). Inoltre possono essere fornite di cerniere.

**MATERIALI:** Corpo e coperchio: lamiera in acciaio AISI 316L. Dadi e viti: acciaio inossidabile.

Guarnizioni in spugna di gomma fissata sul coperchio e sulle flangie.

**ENTRATE CAVI:** fori passanti (GAS UNI 6125, NPT, ISO Metric). A richiesta flangia da 5mm per fori filettati.

NOTE: I pressacavi utilizzati sugli imbrocchi e la morsettiere, devono essere modelli certificati a sicurezza aumentata.



Con flange asportabili / With gland plates

*Boxes series "CSX..." are used in increased safety location Ex-e Zone 1,2,21,22.*

*They are used with terminals for distribution.*

*They are made in stainless steel sheet AISI316L, with or without removable gland plates on each four side (on request will be furnished with one or plus flanges).*

*On request can be supplied complete of hinged.*

**MATERIALS:** Body and cover: stainless steel sheet AISI 316L. Bolt and screws: stainless steel

Seals in rubber sponge, fixed inside the cover and on the flanges.

**ENTRIES:** blank holes (GAS UNI 6125, NPT, ISO Metric). On request 5mm flange for threaded holes.

NOTES: Cable glands used on the hubs and terminals must be certified increased safety model.



in foto versione Senza flange / in photo version Without gland plates



## PULSANTIERE IN ACCIAIO A SICUREZZA AUMENTATA "Ex-ed" "Ex-ed" STAINLESS STEEL INCREASED SAFETY CONTROL STATIONS SERIE - SERIES "CSX"

MODO DI PROTEZIONE - PROTECTION MODE:

II 2 G Ex d e IIC T6 Gb or II 2 G Ex d e ia IIC T6 Gb

**For DUST**

II 2 D Ex tb IIIC T85°C Db IP66 or II 2 D Ex tb IIIC T100°C Db IP66 or II 2 D Ex tb ia IIIC T85°C Db IP66  
(Amb.temperature -40°C to +55°C; -20°C for "ia" version)

CERTIFICATO - CERTIFICATE: ATEX, IECEx, GOST-R

Queste scatole della serie "CSX" sono utilizzate in ambienti a sicurezza aumentata "Ex-e" Zona 1,2,21,22, sono destinate ad essere utilizzate come quadri di segnalazione o di comando con operatori sul coperchio (pulsanti, spie, selettori). Sono realizzate in lamiera inox AISI316L piegata e saldata, possono essere realizzate con o senza flangie asportabili (sui 4 lati, a richiesta è possibile realizzarle su uno o più lati a scelta). Inoltre possono essere fornite di cerniere.

**MATERIALI:** Corpo e coperchio: lamiera in acciaio AISI 316L. Dadi e viti: acciaio inossidabile.

Guarnizioni in spugna di gomma fissata sul coperchio e sulle flangie.

**ENTRATE CAVI:** fori passanti o a richiesta filettati su flangia da min. 3 mm tipo (GAS UNI 6125, NPT, ISO Metric).

*Boxes series "CSX..." are used in increased safety location Ex-e Zone 1,2,21,22. They are used as signalling and command box with operators on cover (pushbutton, indicators light, selectors).*

*They are made in stainless steel sheet AISI316L, with or without removable flanges on each four side (on request will be furnished with one or plus flanges).*

*On request can be supplied complete of hinged.*

**MATERIALS:** Body and cover: stainless steel sheet AISI 316L. Bolt and screws: stainless steel

Seals in rubber sponge, fixed inside the cover and on the flanges.

**ENTRIES:**

blank holes or on request flanges min. thickness 3mm for threaded holes type (GAS UNI 6125, NPT, ISO Metric).



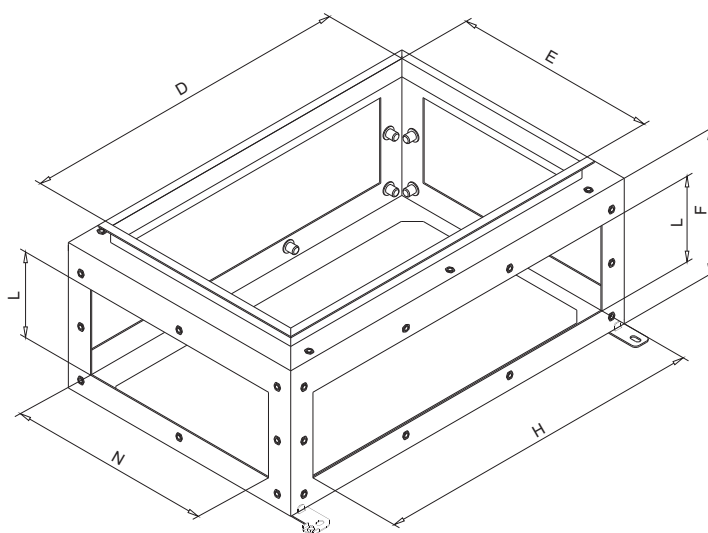
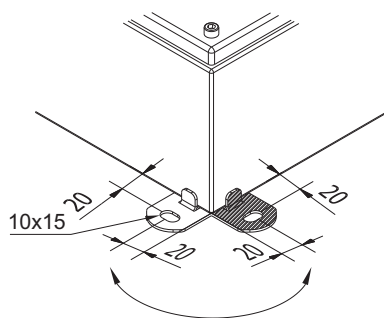
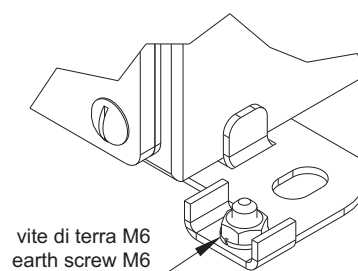
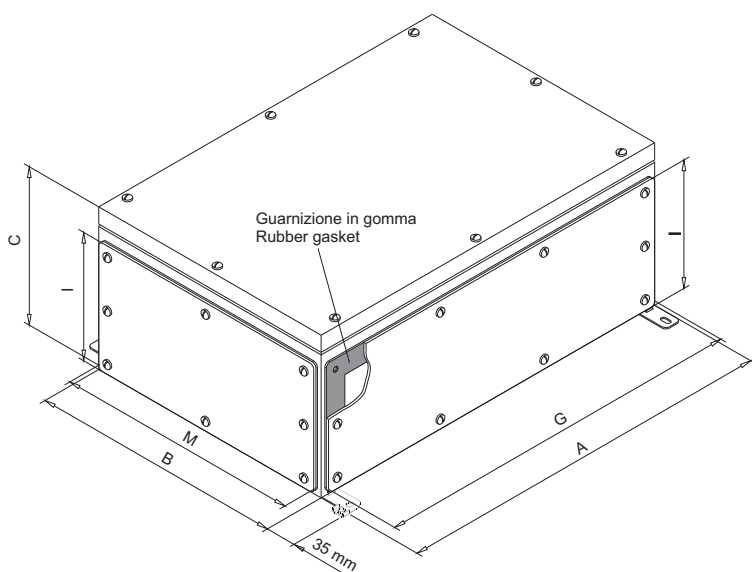

CODICE CODE	DIMENSIONI - DIMENSIONS						Flangia Lato Lungo Flange Long Side				Flangia Lato Corto Flange Short Side				Dimensioni piastra interna Internal plate dimensions	Versioni IECEx IECEx Versions
	A	B	C	D	E	F	G	H	I	L	M	N	I	L		
CSX 151514	150	150	140	90	90	120	140	100	104	56	140	100	104	56	100x85	
CSX 201514	200	150	140	140	90	120	190	150	104	56	140	100	104	56	150x85	X
CSX 302014	300	200	140	240	140	120	290	250	104	56	190	150	104	56	250x135	X
CSX 303014	300	300	140	240	240	120	290	250	104	56	290	250	104	56	250x135	
CSX 453014	450	300	140	390	240	120	440	400	104	56	290	250	104	56	400x235	
CSX 454514	450	450	140	390	390	120	440	400	104	56	440	400	104	56	400x385	
CSX 594514	590	450	140	530	390	120	580	540	104	56	440	400	104	56	540x385	
CSX 595914	590	590	140	530	530	120	580	540	104	56	580	540	104	56	540x525	
CSX 705014	700	500	140	640	440	120	690	650	104	56	490	450	104	56	650x435	
CSX 807014	800	700	140	740	640	120	790	750	104	56	690	650	104	56	750x635	
CSX 302019	300	200	190	240	140	170	290	250	154	106	190	150	154	106	250x135	X
CSX 303019	300	300	190	240	240	170	290	250	154	106	290	250	154	106	250x235	
CSX 453019	450	300	190	390	240	170	440	400	154	106	290	240	154	106	400x235	X
CSX 454519	450	450	190	390	390	170	440	400	154	106	440	400	154	106	400x385	
CSX 594519	590	450	190	530	390	170	580	540	154	106	440	400	154	106	540x385	
CSX 595919	590	590	190	530	530	170	580	540	154	106	580	540	154	106	540x525	
CSX 705019	700	500	190	640	440	170	690	650	154	106	490	450	154	106	650x435	
CSX 807019	800	700	190	740	640	170	790	750	154	106	690	650	154	106	750x635	
CSX 118019	1180	800	190	1120	740	170	1170	1130	154	106	790	750	154	106	1130x735	



## PULSANTIERE IN ACCIAIO A SICUREZZA AUMENTATA "Ex-de" "Ex-de" STAINLESS STEEL INCREASED SAFETY CONTROL STATIONS SERIE - SERIES "SD"

MODO DI PROTEZIONE - PROTECTION MODE:  
II 2 G Ex d e IIC T6 Gb / II 2 D Ex tb IIIC T85°C Db IP66  
II 2(1) G Ex d e [ja Ga] IIC T6 Gb / II 2(1) D Ex tb [jaD Da] IIIC T85°C Db IP66

Ambient Temperature: -40°C to +55°C / -20°C to +40°C (ia)

CERTIFICATO - CERTIFICATE: ATEX, IECEx, GOST-R

Queste scatole della serie "SD.." sono utilizzate in ambienti classificati come Zona 1,2,21,22 in cui sia richiesto un modo di protezione a sicurezza aumentata "Ex-e", vengono equipaggiate con operatori di comando "Ex-de" riportati a pagina 2.X tipo pulsanti, spie, selettori, amperometri e potenziometri.

Sono realizzate in lamiera inox AISI316L piegata e saldata, con finitura tipo scotch brite

**MATERIALI:** Corpo e coperchio: lamiera in acciaio AISI 316L. Dadi e viti: acciaio inossidabile.

Guarnizioni in spugna di gomma fissata sul coperchio.

**ENTRATE CAVI:** fori passanti per filettature tipo GAS, NPT, ISO Metric.

*Boxes series "SD.." are used classified area as Ex-e Zone 1,2,21,22, with required increased safety protection mode, can be equipped with command operators "Ex-de", listed at page 2.X, type pushbutton, indicators light, selectors switch, ammeter and potentiometer.*

*They are made in stainless steel sheet AISI316L superficial finishing type scotch brite*

**MATERIALS:** Body and cover: stainless steel sheet AISI 316L. Bolt and screws: stainless steel

Seals in rubber sponge, fixed inside the cover.

**ENTRIES:** blank holes for thread type GAS, NPT, ISO Metric.



codice / code	lato lungo long side mm	lato corto short side mm	altezza Width mm	n° operatori max n° operators			
				single operators operatori singoli	double operators operatori doppi	ammeter amperom.	switches 4x16A sezionatori 4x16A
SD151612EX	160	150	120	6	3	1+1op.	1
SD102809EX	280	100	90	4	4	2 o/or 1+3op.	2
SD102209EX	220	100	90	3	3	2 o/or 1+2op.	1
SD101609EX	160	100	90	2	2	1	1
SD101009EX	100	100	90	1	1	1	1

Note: IECEx version only for model SD102809EX;  
Nota: versione IECEx solo per il modello SD102809EX



## COMPONENTI Ex-de COMPONENTS Ex-de

### ADV0201 Explosion-proof switch module

Ex mark:  $\text{Ex II 2G}$  Ex de IIC

Intended use: Can be used in zone 1 and zone 2

Ambient temperature use:  $-55^{\circ}\text{C} \leq T_a \leq 60^{\circ}\text{C}$

Degree of protection: IP20

Rated voltage:	250V	250V	110V	24V
----------------	------	------	------	-----

Regimentation use:	AC12	AC15	DC13	DC13
--------------------	------	------	------	------

Rated current:	16A	10A	0.5A	1A
----------------	-----	-----	------	----

Ambient temperature:	$T_a \leq 40^{\circ}\text{C}$	$T_a \leq 60^{\circ}\text{C}$	$T_a \leq 60^{\circ}\text{C}$	$T_a \leq 60^{\circ}\text{C}$
----------------------	-------------------------------	-------------------------------	-------------------------------	-------------------------------

Mechanical life: 100,000 times

Board front type mounting: May be held on mounting rails

TS35 7.5 or with screws

Board back type mounting: On 1-6mm panel

Meet the standard: IEC60079 EN60079



Board front type explosion-proof switch module



Board back type explosion-proof switch module

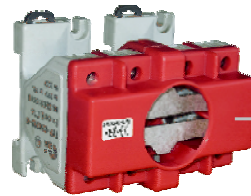

Board front type explosion-proof 4-pole switch module

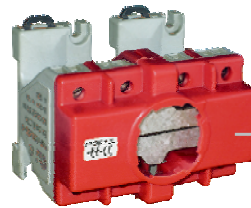

Board back type explosion-proof 4-pole switch module

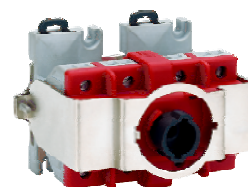
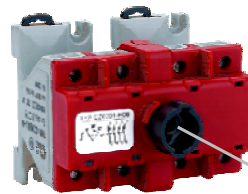

Operation head



P1



P2



P3



P4



Y0



Y1



K□



S□



H□

### P□/K□/□/...Series operation head

Ex mark:  $\text{Ex II 2GD}$  Ex eII Ex tD A21

Intended use: Can be used in zone 1 and zone 2

Can be used in zone 21 and zone 22

Ambient temperature use:  $-40^{\circ}\text{C} \leq T_a \leq 55^{\circ}\text{C}$

Degree of protection: IP66

Material: polyamide

Meet the standard: IEC60079 IEC61241 EN60079 EN61241





## COMPONENTI Ex-de COMPONENTS Ex-de

• Order specifications:

Illustration	Construction type	Type	Button contact	Order No.(Code)
	Board front type	P1 Rubber sheath button	1NC/1NO	0201-60-P1□□
			2NC	0201-61-P1□□
			2NO	0201-62-P1□□
	Board back type		1NC/1NO	0201-70-P1□□
			2NC	0201-71-P1□□
			2NO	0201-72-P1□□
	Board front type	P2 Rubber sheath double button	1NC/1NO	0201-60-P2□□□□
			2NC	0201-61-P2□□□□
			2NO	0201-62-P2□□□□
	Board back type		1NC/1NO	0201-70-P2□□□□
			2NC	0201-71-P2□□□□
			2NO	0201-72-P2□□□□

• Label:





Code	Engraved words in the label	Colour of label	Colour of engraved words
01	Blank	Green	
02	I	Green	white
03	ON	Green	white
04	START	Green	white
21	Blank	red	
22	O	red	white
23	OFF	red	white
24	STOP	red	white
41	Blank	white	
42	II	white	black
43	↑	white	black
44	Start	white	black
45	Stop	white	red
46	IE FW	white	black
47	BW	white	black
48	Stop	white	red
49	↑ ↑	white	black
61	Blank	yellow	
62	II	yellow	white
81	Blank	black	



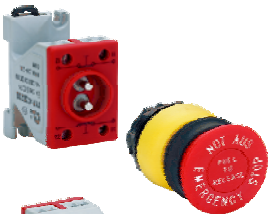

## COMPONENTI Ex-de COMPONENTS Ex-de

- Order specifications:

Illustration	Construction type	Type	Button contact	Order No.(Code)
	Board front type	P3 Emergency self-locking button	$\begin{matrix} 11 & 23 \\   &   \\ \vdots & \vdots \\ 12 & 24 \end{matrix}$ 1NC/1NO	0201-60-P3
			$\begin{matrix} 11 & 21 \\   &   \\ \vdots & \vdots \\ 12 & 22 \end{matrix}$ 2NC	0201-61-P3
			$\begin{matrix} 13 & 23 \\   &   \\ \vdots & \vdots \\ 14 & 24 \end{matrix}$ 2NO	0201-62-P3
	Board back type		$\begin{matrix} 11 & 23 \\   &   \\ \vdots & \vdots \\ 12 & 24 \end{matrix}$ 1NC/1NO	0201-70-P3
			$\begin{matrix} 11 & 21 \\   &   \\ \vdots & \vdots \\ 12 & 22 \end{matrix}$ 2NC	0201-71-P3
			$\begin{matrix} 13 & 23 \\   &   \\ \vdots & \vdots \\ 14 & 24 \end{matrix}$ 2NO	0201-72-P3
	Board front type	P4 Black mushroom head button	$\begin{matrix} 11 & 23 \\   &   \\ \vdots & \vdots \\ 12 & 24 \end{matrix}$ 1NC/1NO	0201-60-P4
			$\begin{matrix} 11 & 21 \\   &   \\ \vdots & \vdots \\ 12 & 22 \end{matrix}$ 2NC	0201-61-P4
			$\begin{matrix} 13 & 23 \\   &   \\ \vdots & \vdots \\ 14 & 24 \end{matrix}$ 2NO	0201-62-P4
	Board back type		$\begin{matrix} 11 & 23 \\   &   \\ \vdots & \vdots \\ 12 & 24 \end{matrix}$ 1NC/1NO	0201-70-P4
			$\begin{matrix} 11 & 21 \\   &   \\ \vdots & \vdots \\ 12 & 22 \end{matrix}$ 2NC	0201-71-P4
			$\begin{matrix} 13 & 23 \\   &   \\ \vdots & \vdots \\ 14 & 24 \end{matrix}$ 2NO	0201-72-P4
	Board front type	Y0 Red mushroom button with key	$\begin{matrix} 11 & 23 \\   &   \\ \vdots & \vdots \\ 12 & 24 \end{matrix}$ 1NC/1NO	0201-60-Y0
			$\begin{matrix} 11 & 21 \\   &   \\ \vdots & \vdots \\ 12 & 22 \end{matrix}$ 2NC	0201-61-Y0
			$\begin{matrix} 13 & 23 \\   &   \\ \vdots & \vdots \\ 14 & 24 \end{matrix}$ 2NO	0201-62-Y0
	Board back type		$\begin{matrix} 11 & 23 \\   &   \\ \vdots & \vdots \\ 12 & 24 \end{matrix}$ 1NC/1NO	0201-70-Y0
			$\begin{matrix} 11 & 21 \\   &   \\ \vdots & \vdots \\ 12 & 22 \end{matrix}$ 2NC	0201-71-Y0
			$\begin{matrix} 13 & 23 \\   &   \\ \vdots & \vdots \\ 14 & 24 \end{matrix}$ 2NO	0201-72-Y0
	Board front type	Y1 Button with key	$\begin{matrix} 11 & 23 \\   &   \\ \vdots & \vdots \\ 12 & 24 \end{matrix}$ 1NC/1NO	0201-60-Y1
			$\begin{matrix} 11 & 21 \\   &   \\ \vdots & \vdots \\ 12 & 22 \end{matrix}$ 2NC	0201-61-Y1
			$\begin{matrix} 13 & 23 \\   &   \\ \vdots & \vdots \\ 14 & 24 \end{matrix}$ 2NO	0201-62-Y1
	Board back type		$\begin{matrix} 11 & 23 \\   &   \\ \vdots & \vdots \\ 12 & 24 \end{matrix}$ 1NC/1NO	0201-70-Y1
			$\begin{matrix} 11 & 21 \\   &   \\ \vdots & \vdots \\ 12 & 22 \end{matrix}$ 2NC	0201-71-Y1
			$\begin{matrix} 13 & 23 \\   &   \\ \vdots & \vdots \\ 14 & 24 \end{matrix}$ 2NO	0201-72-Y1



## COMPONENTI Ex-de COMPONENTS Ex-de

- Outline dimensions:

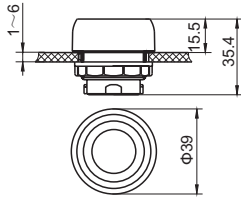

P1 Operation head of rubber sheath button

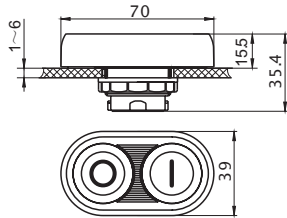

P2 Operation head of rubber sheath double button

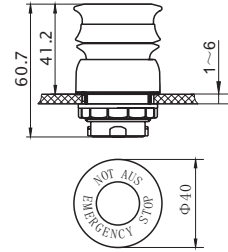

P3 Operation head of emergency self-locking button

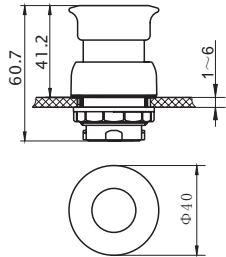

P4 Operation head of black mushroom head button

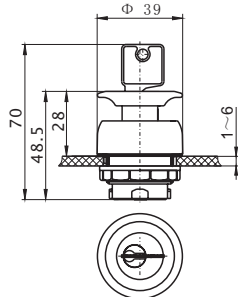

Y0 Operation head of red mushroom button with key

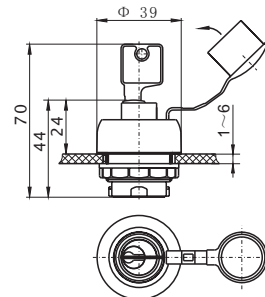

Y1 Operation head of button with key

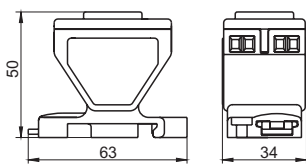

ADV0201 Broad front type explosion-proof switch module

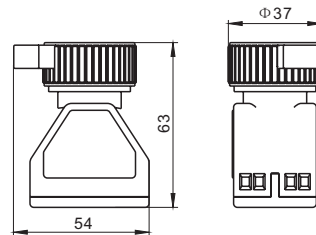

ADV0201 Board back type explosion-proof switch module

- Mounting pitches:

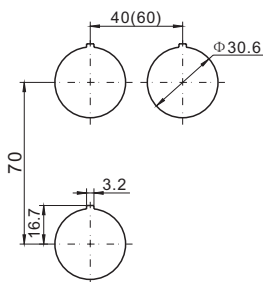

- 

Outline dimensions of board back type with operation head

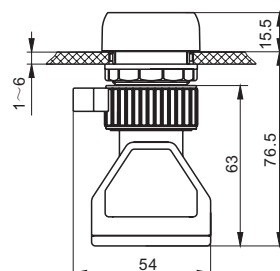





## COMPONENTI Ex-de COMPONENTS Ex-de

### ADV0202 series, Signal Lamp

Ex mark: Ex II 2G Ex de IIC

Intended use: Can be used in zone 1 and zone 2

Ambient temperature use:  $-55^{\circ}\text{C} \leq \text{Ta} \leq 60^{\circ}\text{C}$

Degree of protection: IP20

Rated voltage: AC24-240V DC24-36V

Power consumption:  $P_{\text{max}} \leq 1\text{W}$

Light source: LED

Electric life: One hundred thousand hours

Board front type mounting: May be held on mounting rails

TS35 7.5 or with screws

Board back type mounting: On 1-6mm panel

Meet the standard: IEC60079 EN60079



Board front type



Board back type

Colour of bezel	The voltage of signal lamp module	Colour or lamp head	Order No.(Code)
Red Green Yellow Blue White	AC24V - 240V DC24V - 36V	Red Green Yellow Blue White	0202-□R1-LR 0202-□G1-LG 0202-□Y1-LY 0202-□B1-LB 0202-□W1-LW

6 — Board front type

7 — Board back type

### Outline dimensions:

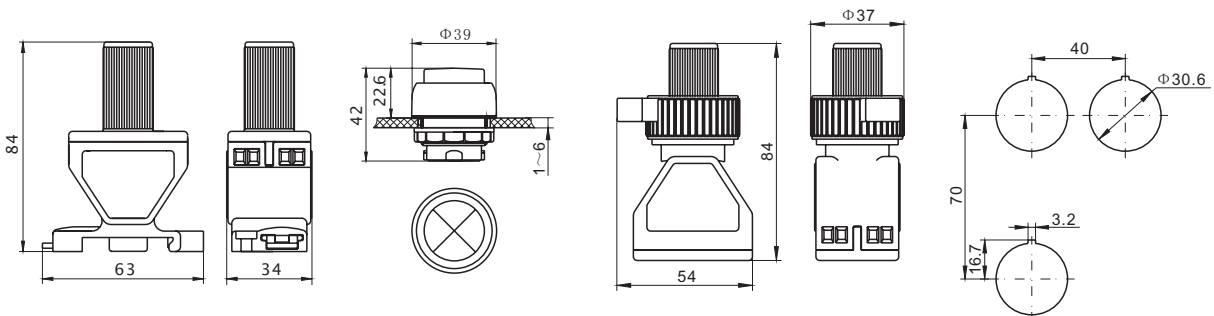

Board front type

L□ Cover of signal lamp

Board back type

Mounting pitches



## COMPONENTI Ex-de COMPONENTS Ex-de

### ADV0212 series, Signal Lamp with Button

Ex mark: Ex de IIC

Intended use: Can be used in zone 1 and zone 2

Ambient temperature use:  $-55^{\circ}\text{C} \leq \text{Ta} \leq 60^{\circ}\text{C}$

Degree of protection: IP20

Button: Conventional closed heating current: 10A

Rated voltage: 250V 24V

Regimentation use: AC15 DC13

Rated current: 6A 1A

Mechanical life: 300,000 times

Signal lamp : Light source: LED Power consumption:  $P_{\text{max}} \leq 1\text{W}$

Rated voltage: AC24-240V DC24-36V

Electric life: One hundred thousand hours

Board front type mounting: May be held on mounting rails

TS35 7.5 or with screws

Board back type mounting: On 1-6mm panel

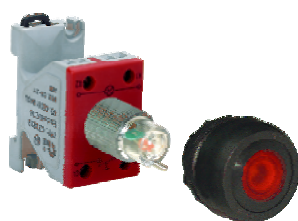

Board front type



Board back type

Colour of operation head	Button contact / the voltage of signal lamp	Colour of lamp head	Order No.(Code)
Red	 1NC	Red	0212-□3R1-PR
Green		Green	0212-□3G1-PG
Yellow		Yellow	0212-□3Y1-PY
Blue		Blue	0212-□3B1-PB
White		White	0212-□3W1-PW
Red	 1NO	Red	0212-□4R1-PR
Green		Green	0212-□4G1-PG
Yellow		Yellow	0212-□4Y1-PY
Blue		Blue	0212-□4B1-PB
White		White	0212-□4W1-PW

6 — Board front type  
7 — Board back type

### Outline dimensions:

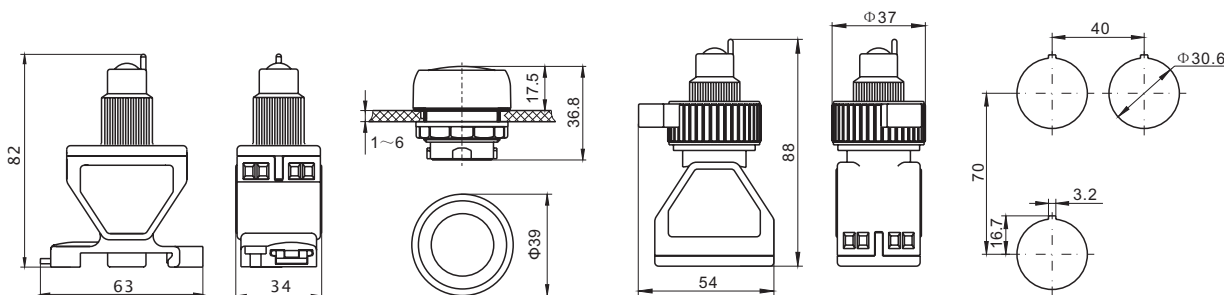

Board front type

□ Operation head of signal lamp with button

Board back type

Mounting pitches



## COMPONENTI Ex-de COMPONENTS Ex-de

### P□/K□/L□/...Series operation head

Ex mark: ⓂI2GD Ex eII Ex tDA21

Intended use: Can be used in zone 1 and zone 2

Can be used in zone 21 and zone 22

Ambient temperature use:  $-40^{\circ}\text{C} \leq \text{Ta} \leq 55^{\circ}\text{C}$

Degree of protection: IP66

Material: Polyamide







Meet the standard: IEC60079 EN60079 IEC61241 EN61241

Conformity to: 0722

	Description	Direction of Anchor Point	Order No.	
P1	Operation head of rubber sheath button With including label "0, I, START, STOP".		P1	
	Operation head of rubber sheath double button With including label "0, I, START, STOP".		P2	
P2	Operation head of emergency self-locking button With engraved letters "NOT AUS EMERGENCY STOP"		P3	
	Operation head of black mushroom head button		P4	
P3	Operation head of red mushroom button with key Press by hand, the key releases		Y02	
P4	Operation head of button with key May lock in the initial position; May take out the key in the initial position		Y12	
	<div style="display: flex; align-items: center;"> <div style="writing-mode: vertical-rl; transform: rotate(180deg); font-size: small; margin-right: 10px;">Operation head of switch</div> </div>	0 Self-reset, II Self-reset		K41 S41
				K42 S42
				K51 S51
				K52 S52
				K61 S61
				K62 S62
				K81 S81
				K82 S82
K□	Operation head of 4-pole switch		H11	
			H12	
S□ H□	L Signal lamp		Red LR	
	Green LG			
	Yellow LY			
	Blue LB			
	White LW			
L□	Operation head of signal lamp with button		Red PR	
	Green PG			
	Yellow PY			
	Blue PB			
P□	White PW			



## COMPONENTI Ex-de COMPONENTS Ex-de

	Description	Direction of Anchor Point	Order No.
DW □ 	Operation head of potentiometer setting		DW1
			DW2
B1 	Stopping plug: Seal the unused aperture on the front panel.		B1
EXM 	Calotte: Protective window for measuring meter		EXM

### ADV0201 Series explosion-proof switch module

#### Explosion-proof 2-pole switch module



Switch contact	Order No.
1NC/1NO	0201-□0
2NC	0201-□1
2NO	0201-□2
6 - Board front type	
7 - Board back type	
9 - Board back unit type	

#### Explosion-proof 4-pole switch module

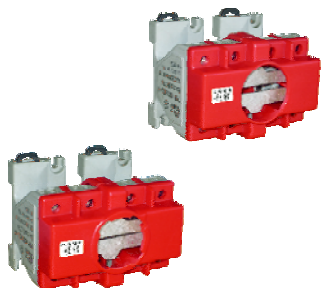

Switch contact	Order No.
2NC/2NO	0201-□50
4NC	0201-□51
4NO	0201-□52
1NC/3NO	0201-□53
3NC/1NO	0201-□54
6 - Board front type	
7 - Board back type	

#### Explosion-proof 4-pole switch module



Contact schematic for operating position	Order No.
See page A / 27 contact schematic	0201-H□ □□□□
6 - Board front type	
7 - Board back type	
Code of switch contact schematic	



## COMPONENTI Ex-de COMPONENTS Ex-de

### ADV0205 series, Ammeter

Ex mark:  $\text{Ex} \text{II} 2 \text{G}$  Ex ell

Intended use: Can be used in zone 1 and zone 2

Ambient temperature use:  $-40^{\circ}\text{C} \leq T_a \leq 60^{\circ}\text{C}$

Ammeter framework: Electromagnetic

Accuracy class: 1.5

Overload scale: 2 times, 5 times

Board front type mounting: May be held on mounting rails

TS35 7.5 or with screws

Board back type mounting: On 1-6mm panel

Meet the standard: IEC60079 EN60079

Conformity to:  $\text{CE}$  0575



Board front type



Board back type



EXM Calotte

Calotte	Measuring way	Overload scale	Measuring range	Order No.(Code)
EXM		2	0-1 / 2A 0-4 / 8A 0-5 / 10A 0-10 / 20A 0-15 / 30A	M□DA 1 M□DA 4 M□DA 5 M□DA 10 M□DA 15
		2	0-1 / 2A 0-2.5 / 5A 0-5 / 10A 0-15 / 30A 0-25 / 50A 0-40 / 80A 0-50 / 100A 0-60 / 120A 0-75 / 150A 0-100 / 200A 0-150 / 300A 0-200 / 400A 0-250 / 500A 0-300 / 600A 0-400 / 800A 0-500 / 1000A 0-600 / 1200A	M□WA 01 / □-2 M□WA 2.5 / □-2 M□WA 5 / □-2 M□WA 15 / □-2 M□WA 25 / □-2 M□WA 40 / □-2 M□WA 50 / □-2 M□WA 60 / □-2 M□WA 75 / □-2 M□WA 100 / □-2 M□WA 150 / □-2 M□WA 200 / □-2 M□WA 250 / □-2 M□WA 300 / □-2 M□WA 400 / □-2 M□WA 500 / □-2 M□WA 600 / □-2
		5	0-1 / 5A 0-2.5 / 12.5A 0-5 / 25A 0-15 / 75A 0-25 / 125A 0-40 / 200A 0-50 / 250A 0-60 / 300A 0-75 / 375A 0-100 / 500A 0-150 / 750A 0-200 / 1000A 0-250 / 1250A 0-300 / 1500A 0-400 / 2000A 0-500 / 2500A 0-600 / 3000A	M□WA 01 / □-5 M□WA 2.5 / □-5 M□WA 5 / □-5 M□WA 15 / □-5 M□WA 25 / □-5 M□WA 40 / □-5 M□WA 50 / □-5 M□WA 60 / □-5 M□WA 75 / □-5 M□WA 100 / □-5 M□WA 150 / □-5 M□WA 200 / □-5 M□WA 250 / □-5 M□WA 300 / □-5 M□WA 400 / □-5 M□WA 500 / □-5 M□WA 600 / □-5
		6 — Board front type 7 — Board back type	Connect to the secondary current transformer	5A <input type="checkbox"/> 1A <input type="checkbox"/>