

ESECUZIONE: EEx e II IP66  
EEx E [ia] IIC IP66  
EEx d [ia] IIC IP66

CERTIFICATO: KEMA 01ATEX2256

zona 1 - zona 2 - zona 21 - zona 22 - zona 0 - zona 20

Caratteristiche : Casseta con guarnizione in EPDM

Materiali : Poliestere caricato con fibra di vetro

T amb. standard -40°C +40°C - T6 (T 80°C)

-40°C +60°C - T5 (T 95°C)

T amb. special -40°C +80°C - T4 (T 130°C) guarnizione in silicone

EXECUTION: EEx e II IP66  
EEx E [ia] IIC IP66  
EEx d [ia] IIC IP66

CERTIFICATE: KEMA 01ATEX2256

zone 1 - zone 2 - zone 21 - zone 22 - zone 0 - zone 20

Features : Enclosure with EPDM gasket and stainless steel fastening screw

Materials : Fiberglass reinforced polyester

T amb. standard -40°C +40°C - T6 (T 80°C)

-40°C +60°C - T5 (T 95°C)

T amb. special -40°C +80°C - T4 (T 130°C) silicon gasket



DENOMIN. DESIGNAT.	DIMENSIONI ESTERNE EXTERNAL DIMENSIONS			DIMENSIONI INTERNE INTERNAL DIMENSIONS			Fissaggio Mounting	
	A	B	C	a	b	c	x	y
sigla - item								
GWM 99	95	95	63	87	87	44	55	80
GWM 1414	140	140	82	132	132	61	95	122
GWR 178	175	85	120	166	76	105	123	162
GWR 1717	175	175	120	166	166	105	123	162
GWR 3617	360	175	120	351	166	105	308	162
GWR 3636	360	360	120	351	351	105	308	346



C Flangia cieca - Flangia di accoppiamento  
Blind flange - Connection flange

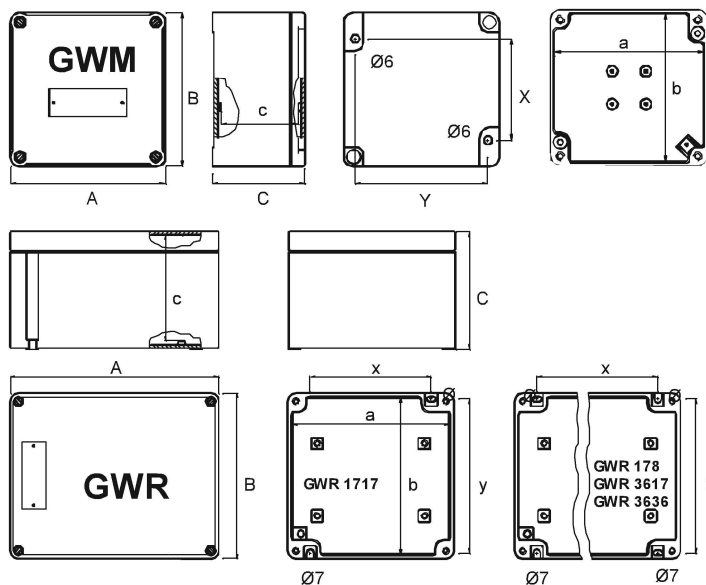
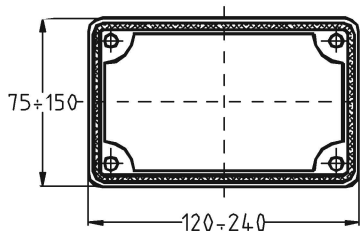

Foro per filettatura ISO 7/1 - NPT / Ø" hole	1/2	3/4	1	1 1/4	1 1/2	2	2 1/2	3	4
Foro per filettatura ISO metrica / Hole for ISO metric	M20	M25	M32	M40	M50	M63	M75	M90	-
Simbolo / Symbol	1	2	3	4	5	6	7	8	9

Schema di foratura per pressacavi (altre configurazioni a richiesta)  
Arrangements of drilled holes with cable glands (other configuration upon request)

Codice - Code	Schema - Arrangement	Lato - Side	1/2"	3/4"	1	1 1/4"	1 1/2"	2	2 1/2"	3"	4"
GWM 99	Libero/free	A/C	1	1	-	-	-	-	-	-	-
		B/D	1	1	-	-	-	-	-	-	-
GWM 1414	Libero/free	A/C	2	2	1	-	-	-	-	-	-
		B/D	2	2	1	-	-	-	-	-	-
GWR 178	Libero/free	A/C	6	3	2	2	2	1	-	-	-
		B/D	2	1	1	1	1	1	-	-	-
GWR 1717	Libero/free	A/C	6	3	2	2	2	1	-	-	-
		B/D	3	3	2	2	2	1	-	-	-
GWR 3617	Libero/free	A/C	12	6	5	4	4	3	-	-	-
		B/D	6	3	2	2	2	1	-	-	-
GWR 3636	Libero/free	A/C	12	6	5	4	4	3	-	-	-
		B/D	12	6	5	4	4	3	-	-	-