



## SCATOLE DI DERIVAZIONE "Ex-e" "Ex-ia" SERIE "CSA" "Ex-e" "Ex-ia" JUNCTION BOXES SERIES "CSA"

MODO DI PROTEZIONE - PROTECTION MODE:

II 2 G Ex e IIC T6 Gb or II 2 G Ex e IIC T5 Gb or II 2 G Ex ia IIC T6 Gb or II 2 G Ex e ia IIC T6 Gb

**For DUST**

II 2 D Ex tb IIIC T85°C Db IP66 or II 2 D Ex tb IIIC T100°C Db IP66 or II 2 D Ex tb ia IIIC T85°C Db IP66  
(Amb.temperature -40°C to +55°C; -20°C for "ia" version)

CERTIFICATO - CERTIFICATE: ATEX, GOST-R

Queste scatole della serie "CSA" sono utilizzate in ambienti a sicurezza aumentata e intrinseca del Gruppo II, Zona 1,2,21,22

Sono normalmente utilizzati con morsetti per la distribuzione.

**MATERIALI:** Corpo e coperchio: alluminio. Dadi e viti: acciaio inossidabile.

**FILETTATURE ENTRATE CAVI:** a richiesta GAS UNI 6125, NPT, ISO metrica.

**VERNICIATURA STANDARD:** Esterna epossidica color grigio RAL 7037, interna arancio anticondensa RAL2004.

**NOTE:** Guarnizione in spugna di silicone fissata nel vano del coperchio. Le pareti della custodia hanno uno spessore minimo di 7 mm e consentono la realizzazione di imbrocchi filettati. Su richiesta possono essere fornite di porta incernierata. I pressacavi utilizzati sugli imbrocchi devono essere modelli certificati a sicurezza aumentata. La morsettiera deve essere un modello certificato a sicurezza aumentata. I fori di fissaggio non sono all'interno della scatola.

*Boxes series "CSA..." are used in increased or intrinsically safety location for Group II, Zone 1,2,21,22*

*They are normally used with terminals for distribution.*

**MATERIALS:** Body and cover: aluminium. Bolt and screws: stainless steel

**THREADS ENTRIES:** On request: GAS UNI 6125, NPT, ISO metric.

**STANDARD PAINTING:** External grey epoxy RAL 7037, internal anticorrosion orange RAL2004.

**NOTES:** Silicon rubber-sponge gasket cemented in recess of cover. The walls of the enclosures are minimum thickness of 7 mm and permit realization of threads hubs. On request can be supplied complete of hinged door. Cable glands used on the hubs must be certified increased safety model. Terminal block must be certified increased safety model. Fixing holes are not inside the box.

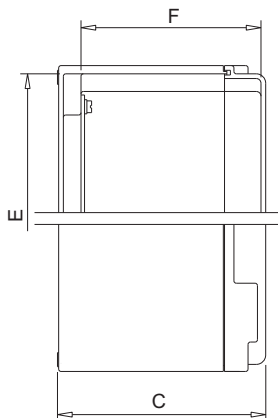
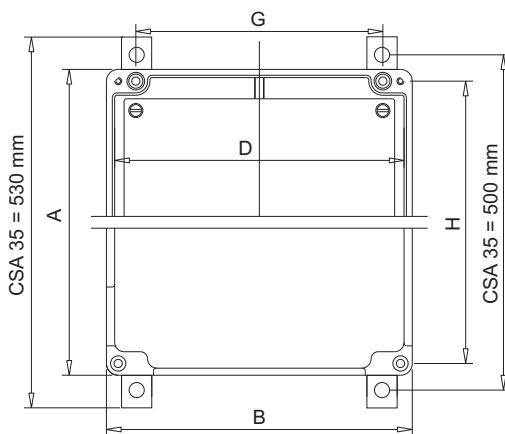

TIPO TYPE	Dimensioni esterne External dimensions			Dimensioni interne Internal dimensions			Fori di fissaggio Fixing holes			Volume Dm <sup>3</sup>	Peso Kg
	A	B	C	D	E	F	G	H	Ø		
CSA 0	128	260	174	246	114	154	210	108	6,5	57,9	3,2
CSA 11	260	260	174	246	246	154	210	240	6,5	117,7	4,7
CSA 12	326	260	174	246	312	154	210	306	6,5	147,5	5,3
CSA 13	393	260	174	246	379	154	210	373	6,5	177,8	6,4
CSA 35	480	480	185	450	450	147	430	-	10	397,9	17,1



## CARATTERISTICHE TECNICHE SERIE "CSA" - CSA TECHNICAL DATA

ESECUZIONE AMMISSIBILE DEGLI IMBOCCHI ADMISSIBLE EXECUTION OF HUBS			1/2"	3/4"	1"	1 1/2"	2"
LATO CORTO - SHORT SIDE	CSA - 0	N° imbocchi - <i>N° hubs</i>	4	2	2	1	1
		N° file - <i>N° rows</i>	2	2	2	-	-
		Interasse - <i>cent. dist.</i>	45	60	60	-	-
	CSA - 11	N° imbocchi - <i>N° hubs</i>	8	8	6	2	2
		N° file - <i>N° rows</i>	2	2	2	1	1
		Interasse - <i>cent. dist.</i>	45	50	60	100	100
	CSA - 12	N° imbocchi - <i>N° hubs</i>	8	8	6	2	2
		N° file - <i>N° rows</i>	2	2	2	1	1
		Interasse - <i>cent. dist.</i>	45	50	60	100	100
	CSA - 13	N° imbocchi - <i>N° hubs</i>	8	8	6	2	2
		N° file - <i>N° rows</i>	2	2	2	1	1
		Interasse - <i>cent. dist.</i>	45	50	60	100	100
CSA - 35	N° imbocchi - <i>N° hubs</i>	21	16	13	5	4	
	N° file - <i>N° rows</i>	3	2	2	1	1	
	Interasse - <i>cent. dist.</i>	30	60	65	90	110	
LATO LUNGO - LONG SIDE	CSA - 0	N° imbocchi - <i>N° hubs</i>	8	8	6	2	2
		N° file - <i>N° rows</i>	2	2	2	1	1
		Interasse - <i>cent. dist.</i>	45	50	60	100	100
	CSA - 11	N° imbocchi - <i>N° hubs</i>	10	8	8	3	2
		N° file - <i>N° rows</i>	2	2	2	1	1
		Interasse - <i>cent. dist.</i>	45	60	60	80	100
	CSA - 12	N° imbocchi - <i>N° hubs</i>	12	10	10	4	3
		N° file - <i>N° rows</i>	2	2	2	1	1
		Interasse - <i>cent. dist.</i>	45	60	60	75	100
	CSA - 13	N° imbocchi - <i>N° hubs</i>	16	12	12	4	4
		N° file - <i>N° rows</i>	2	2	2	1	1
		Interasse - <i>cent. dist.</i>	45	60	60	80	90
	CSA - 35	N° imbocchi - <i>N° hubs</i>	21	16	13	5	4
		N° file - <i>N° rows</i>	3	2	2	1	1
		Interasse - <i>cent. dist.</i>	30	60	65	90	110

NUMERO MASSIMO DI MORSETTI - MAXIMUM NUMBER OF TERMINALS									
SEZIONE DEI MORSETTI - <i>TERMINALS SECTION</i>	2,5	4	6	10	16	25	35	70	
CSA - 0	N° morsetti per guida DIN - <i>N° terminals for each rails DIN</i>	30	26	22	17	14	10	-	-
	N° max guide DIN - <i>N° max rails DIN</i>	1	1	1	1	1	1	-	-
CSA - 11	N° morsetti per guida DIN - <i>N° terminals for each rails DIN</i>	29	25	21	16	13	10	8	7
	N° max guide DIN - <i>N° max rails DIN</i>	3	3	3	2	2	1	1	1
CSA - 12	N° morsetti per guida DIN - <i>N° terminals for each rails DIN</i>	40	35	20	22	18	14	11	10
	N° max guide DIN - <i>N° max rails DIN</i>	3	3	3	2	2	1	1	1
CSA - 13	N° morsetti per guida DIN - <i>N° terminals for each rails DIN</i>	52	45	38	29	24	18	15	13
	N° max guide DIN - <i>N° max rails DIN</i>	3	3	3	2	2	1	1	1
CSA - 35	N° morsetti per guida DIN - <i>N° terminals for each rails DIN</i>	52	45	38	32	27	15	13	12
	N° max guide DIN - <i>N° max rails DIN</i>	5	5	5	3	3	3	2	2

il numero di morsetti è indicativo può variare in funzione della corrente e della temperatura  
the number of terminals is indicative can change as a function of current and temperature



## DIMENSIONI PIASTRA INTERNA PER CUSTODIE CSA DIMENSIONS OF INTERNAL PLATE FOR ENCLOSURES CSA

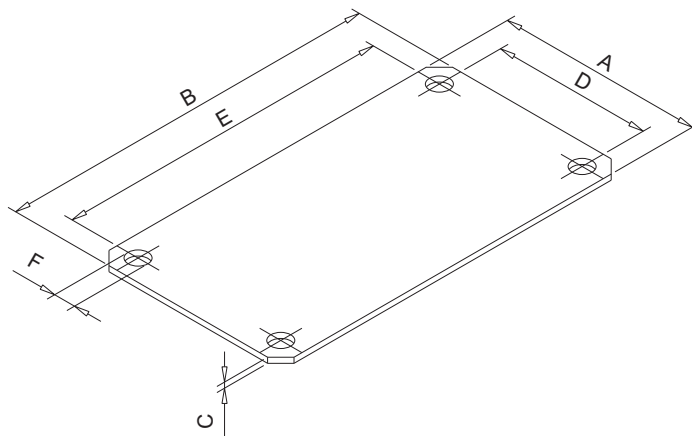

CUSTODIA ENCLOSURE	A	B	C	D	E	F
CSA 11	210	230	2	190	190	8
CSA 12	229	276	2	190	256	8
CSA 13	230	343	2	196	323	8
CSA 35	420	420	2	400	400	8

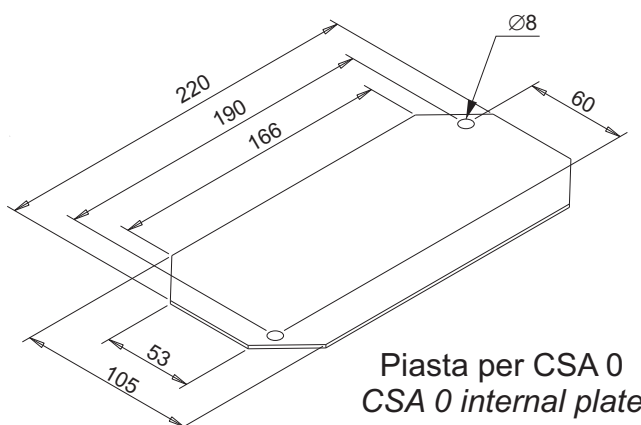



## CUSTODIE SERIE "CSA" A SICUREZZA AUMENTATA Ex-de ENCLOSURE SERIES "CSA" INCREASED SAFETY Ex-de

MODO DI PROTEZIONE - PROTECTION MODE:

II 2 G Ex d e IIC T6 Gb or II 2 G Ex d e ia IIC T6 Gb

**For DUST**

II 2 D Ex tb IIIC T85°C Db IP66 or II 2 D Ex tb IIIC T100°C Db IP66 or II 2 D Ex tb ia IIIC T85°C Db IP66  
(Amb.temperature -40°C to +55°C; -20°C for "ia" version)

CERTIFICATO - CERTIFICATE: ATEX, GOST-R

Queste custodie della serie "CSA" sono utilizzate come quadri di segnalazione o di comando con operatori sul coperchio (pulsanti, spie, selettori)

**MATERIALI:** Corpo e coperchio: alluminio. Dadi e viti: acciaio inossidabile.

**FILETTATURE:** a richiesta: GAS UNI 6125, NPT, ISO Metrica.

**VERNICIATURA STANDARD:** Esterna epossidica color grigio RAL 7037, interna arancio anticondensa RAL2004.

*Enclosures series "CSA..." are used as signaling and command box with operators on cover (pushbutton, indicator lights, selectors).*

**MATERIALS:** Body and cover: aluminium. Bolt and screws: stainless steel

**THREADS:** on request: GAS UNI 6125, NPT, ISO Metric.

**STANDARD PAINTING:** External grey epoxy RAL 7037, internal anticondensation orange RAL2004.

**Per le dimensioni vedere a pagina 2.10 /  
For dimension see page 2.10**



## CUSTODIE STAGNE SERIE "CSA" WATER PROOF ENCLOSURE SERIES "CSA"

GRADO DI PROTEZIONE - PROTECTION DEGREE : IP 66





## COMPONENTI Ex-de COMPONENTS Ex-de

### ADV0201 Explosion-proof switch module

Ex mark:  $\text{Ex II 2G}$  Ex de IIC

Intended use: Can be used in zone 1 and zone 2

Ambient temperature use:  $-55^{\circ}\text{C} \leq T_a \leq 60^{\circ}\text{C}$

Degree of protection: IP20

Rated voltage:	250V	250V	110V	24V
----------------	------	------	------	-----

Regimentation use:	AC12	AC15	DC13	DC13
--------------------	------	------	------	------

Rated current:	16A	10A	0.5A	1A
----------------	-----	-----	------	----

Ambient temperature:	$T_a \leq 40^{\circ}\text{C}$	$T_a \leq 60^{\circ}\text{C}$	$T_a \leq 60^{\circ}\text{C}$	$T_a \leq 60^{\circ}\text{C}$
----------------------	-------------------------------	-------------------------------	-------------------------------	-------------------------------

Mechanical life: 100,000 times

Board front type mounting: May be held on mounting rails

TS35 7.5 or with screws

Board back type mounting: On 1-6mm panel

Meet the standard: IEC60079 EN60079



Board front type explosion-proof switch module



Board back type explosion-proof switch module

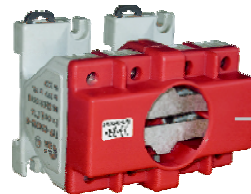

Board front type explosion-proof 4-pole switch module

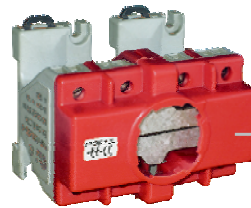

Board back type explosion-proof 4-pole switch module

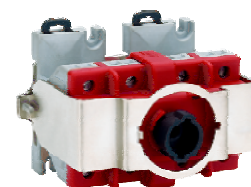
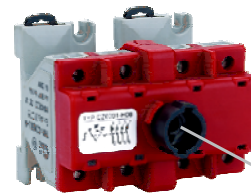

Operation head



P1



P2



P3



P4



Y0



Y1



K□



S□



H□

### P□/K□/□/...Series operation head

Ex mark:  $\text{Ex II 2GD}$  Ex eII Ex tD A21

Intended use: Can be used in zone 1 and zone 2

Can be used in zone 21 and zone 22

Ambient temperature use:  $-40^{\circ}\text{C} \leq T_a \leq 55^{\circ}\text{C}$

Degree of protection: IP66

Material: polyamide

Meet the standard: IEC60079 IEC61241 EN60079 EN61241



## COMPONENTI Ex-de COMPONENTS Ex-de

• Order specifications:

Illustration	Construction type	Type	Button contact	Order No.(Code)
	Board front type	P1 Rubber sheath button	1NC/1NO	0201-60-P1□□
			2NC	0201-61-P1□□
			2NO	0201-62-P1□□
	Board back type		1NC/1NO	0201-70-P1□□
			2NC	0201-71-P1□□
			2NO	0201-72-P1□□
	Board front type	P2 Rubber sheath double button	1NC/1NO	0201-60-P2□□□□
			2NC	0201-61-P2□□□□
			2NO	0201-62-P2□□□□
	Board back type		1NC/1NO	0201-70-P2□□□□
			2NC	0201-71-P2□□□□
			2NO	0201-72-P2□□□□

• Label:





Code	Engraved words in the label	Colour of label	Colour of engraved words
01	Blank	Green	
02	I	Green	white
03	ON	Green	white
04	START	Green	white
21	Blank	red	
22	O	red	white
23	OFF	red	white
24	STOP	red	white
41	Blank	white	
42	II	white	black
43	↑	white	black
44	Start	white	black
45	Stop	white	red
46	IE FW	white	black
47	BW	white	black
48	Stop	white	red
49	↑ ↑	white	black
61	Blank	yellow	
62	II	yellow	white
81	Blank	black	



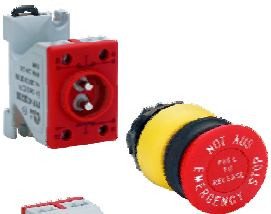

## COMPONENTI Ex-de COMPONENTS Ex-de

- Order specifications:

Illustration	Construction type	Type	Button contact	Order No.(Code)
	Board front type	P3 Emergency self-locking button	$\begin{matrix} 11 & 23 \\   &   \\ \vdots & \vdots \\ 12 & 24 \end{matrix}$ 1NC/1NO	0201-60-P3
			$\begin{matrix} 11 & 21 \\   &   \\ \vdots & \vdots \\ 12 & 22 \end{matrix}$ 2NC	0201-61-P3
			$\begin{matrix} 13 & 23 \\   &   \\ \vdots & \vdots \\ 14 & 24 \end{matrix}$ 2NO	0201-62-P3
	Board back type		$\begin{matrix} 11 & 23 \\   &   \\ \vdots & \vdots \\ 12 & 24 \end{matrix}$ 1NC/1NO	0201-70-P3
			$\begin{matrix} 11 & 21 \\   &   \\ \vdots & \vdots \\ 12 & 22 \end{matrix}$ 2NC	0201-71-P3
			$\begin{matrix} 13 & 23 \\   &   \\ \vdots & \vdots \\ 14 & 24 \end{matrix}$ 2NO	0201-72-P3
	Board front type	P4 Black mushroom head button	$\begin{matrix} 11 & 23 \\   &   \\ \vdots & \vdots \\ 12 & 24 \end{matrix}$ 1NC/1NO	0201-60-P4
			$\begin{matrix} 11 & 21 \\   &   \\ \vdots & \vdots \\ 12 & 22 \end{matrix}$ 2NC	0201-61-P4
			$\begin{matrix} 13 & 23 \\   &   \\ \vdots & \vdots \\ 14 & 24 \end{matrix}$ 2NO	0201-62-P4
	Board back type		$\begin{matrix} 11 & 23 \\   &   \\ \vdots & \vdots \\ 12 & 24 \end{matrix}$ 1NC/1NO	0201-70-P4
			$\begin{matrix} 11 & 21 \\   &   \\ \vdots & \vdots \\ 12 & 22 \end{matrix}$ 2NC	0201-71-P4
			$\begin{matrix} 13 & 23 \\   &   \\ \vdots & \vdots \\ 14 & 24 \end{matrix}$ 2NO	0201-72-P4
	Board front type	Y0 Red mushroom button with key	$\begin{matrix} 11 & 23 \\   &   \\ \vdots & \vdots \\ 12 & 24 \end{matrix}$ 1NC/1NO	0201-60-Y0
			$\begin{matrix} 11 & 21 \\   &   \\ \vdots & \vdots \\ 12 & 22 \end{matrix}$ 2NC	0201-61-Y0
			$\begin{matrix} 13 & 23 \\   &   \\ \vdots & \vdots \\ 14 & 24 \end{matrix}$ 2NO	0201-62-Y0
	Board back type		$\begin{matrix} 11 & 23 \\   &   \\ \vdots & \vdots \\ 12 & 24 \end{matrix}$ 1NC/1NO	0201-70-Y0
			$\begin{matrix} 11 & 21 \\   &   \\ \vdots & \vdots \\ 12 & 22 \end{matrix}$ 2NC	0201-71-Y0
			$\begin{matrix} 13 & 23 \\   &   \\ \vdots & \vdots \\ 14 & 24 \end{matrix}$ 2NO	0201-72-Y0
	Board front type	Y1 Button with key	$\begin{matrix} 11 & 23 \\   &   \\ \vdots & \vdots \\ 12 & 24 \end{matrix}$ 1NC/1NO	0201-60-Y1
			$\begin{matrix} 11 & 21 \\   &   \\ \vdots & \vdots \\ 12 & 22 \end{matrix}$ 2NC	0201-61-Y1
			$\begin{matrix} 13 & 23 \\   &   \\ \vdots & \vdots \\ 14 & 24 \end{matrix}$ 2NO	0201-62-Y1
	Board back type		$\begin{matrix} 11 & 23 \\   &   \\ \vdots & \vdots \\ 12 & 24 \end{matrix}$ 1NC/1NO	0201-70-Y1
			$\begin{matrix} 11 & 21 \\   &   \\ \vdots & \vdots \\ 12 & 22 \end{matrix}$ 2NC	0201-71-Y1
			$\begin{matrix} 13 & 23 \\   &   \\ \vdots & \vdots \\ 14 & 24 \end{matrix}$ 2NO	0201-72-Y1



## COMPONENTI Ex-de COMPONENTS Ex-de

- Outline dimensions:

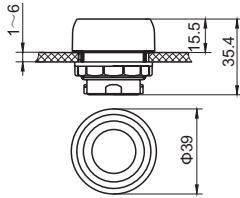

P1 Operation head of rubber sheath button

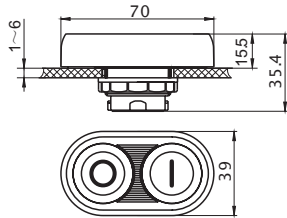

P2 Operation head of rubber sheath double button

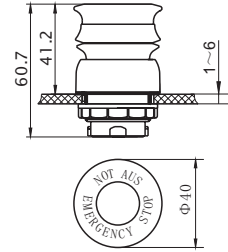

P3 Operation head of emergency self-locking button

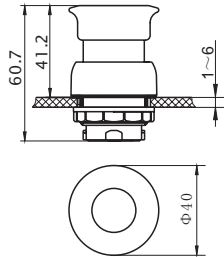

P4 Operation head of black mushroom head button

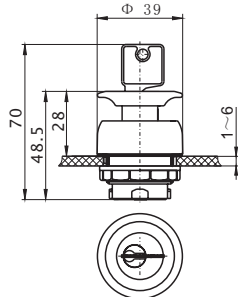

Y0 Operation head of red mushroom button with key

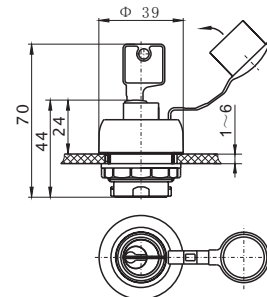

Y1 Operation head of button with key

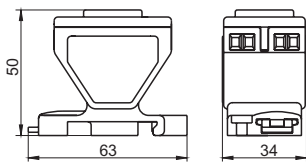

ADV0201 Broad front type explosion-proof switch module

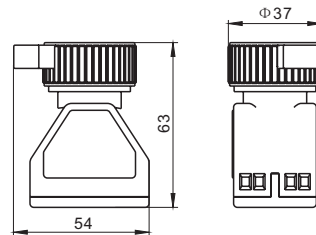

ADV0201 Board back type explosion-proof switch module

- Mounting pitches:

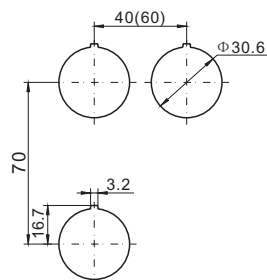

- 

Outline dimensions of board back type with operation head

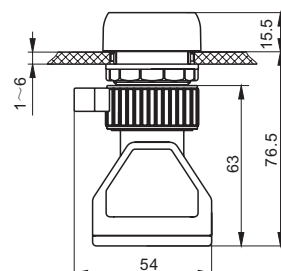





## COMPONENTI Ex-de COMPONENTS Ex-de

### ADV0202 series, Signal Lamp

Ex mark: Ex II 2G Ex de IIC

Intended use: Can be used in zone 1 and zone 2

Ambient temperature use:  $-55^{\circ}\text{C} \leq \text{Ta} \leq 60^{\circ}\text{C}$

Degree of protection: IP20

Rated voltage: AC24-240V DC24-36V

Power consumption:  $P_{\text{max}} \leq 1\text{W}$

Light source: LED

Electric life: One hundred thousand hours

Board front type mounting: May be held on mounting rails

TS35 7.5 or with screws

Board back type mounting: On 1-6mm panel

Meet the standard: IEC60079 EN60079



Board front type



Board back type

Colour of bezel	The voltage of signal lamp module	Colour or lamp head	Order No.(Code)
Red Green Yellow Blue White	AC24V - 240V DC24V - 36V	Red Green Yellow Blue White	0202-□R1-LR 0202-□G1-LG 0202-□Y1-LY 0202-□B1-LB 0202-□W1-LW

6 — Board front type

7 — Board back type

### Outline dimensions:

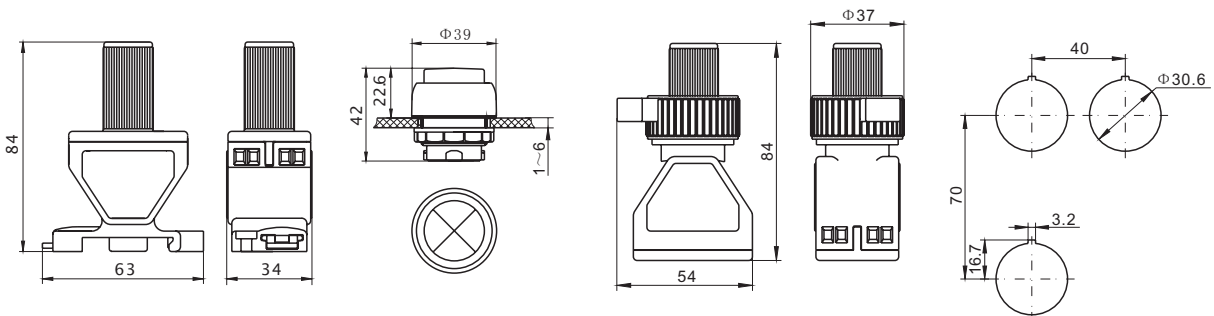

Board front type

L□ Cover of signal lamp

Board back type

Mounting pitches



## COMPONENTI Ex-de COMPONENTS Ex-de

### ADV0212 series, Signal Lamp with Button

Ex mark: Ex de IIC

Intended use: Can be used in zone 1 and zone 2

Ambient temperature use:  $-55^{\circ}\text{C} \leq \text{Ta} \leq 60^{\circ}\text{C}$

Degree of protection: IP20

Button: Conventional closed heating current: 10A

Rated voltage: 250V 24V

Regimentation use: AC15 DC13

Rated current: 6A 1A

Mechanical life: 300,000 times

Signal lamp : Light source: LED Power consumption:  $P_{\text{max}} \leq 1\text{W}$

Rated voltage: AC24-240V DC24-36V

Electric life: One hundred thousand hours

Board front type mounting: May be held on mounting rails

TS35 7.5 or with screws

Board back type mounting: On 1-6mm panel

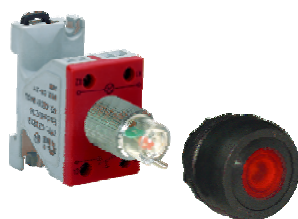

Board front type



Board back type

Colour of operation head	Button contact / the voltage of signal lamp	Colour of lamp head	Order No.(Code)
Red	 1NC	Red	0212-□3R1-PR
Green		Green	0212-□3G1-PG
Yellow		Yellow	0212-□3Y1-PY
Blue		Blue	0212-□3B1-PB
White		White	0212-□3W1-PW
Red	 1NO	Red	0212-□4R1-PR
Green		Green	0212-□4G1-PG
Yellow		Yellow	0212-□4Y1-PY
Blue		Blue	0212-□4B1-PB
White		White	0212-□4W1-PW

6 — Board front type  
7 — Board back type

### Outline dimensions:

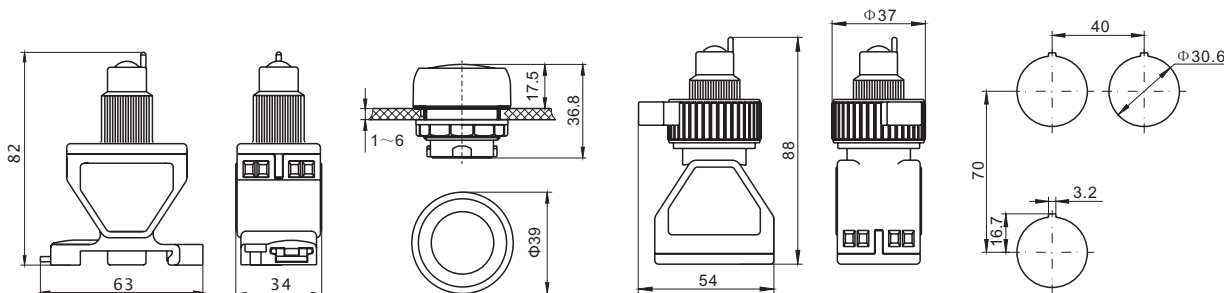

Board front type

□ Operation head of signal lamp with button

Board back type

Mounting pitches



## COMPONENTI Ex-de COMPONENTS Ex-de

### P□/K□/L□/...Series operation head

Ex mark: ⓂI2GD Ex eII Ex tDA21

Intended use: Can be used in zone 1 and zone 2

Can be used in zone 21 and zone 22

Ambient temperature use:  $-40^{\circ}\text{C} \leq \text{Ta} \leq 55^{\circ}\text{C}$

Degree of protection: IP66

Material: Polyamide







Meet the standard: IEC60079 EN60079 IEC61241 EN61241

Conformity to: 0722

	Description	Direction of Anchor Point	Order No.
P1	Operation head of rubber sheath button With including label "0, I, START, STOP".		P1
	Operation head of rubber sheath double button With including label "0, I, START, STOP".		P2
P2	Operation head of emergency self-locking button With engraved letters "NOT AUS EMERGENCY STOP"		P3
	Operation head of black mushroom head button		P4
P3	Operation head of red mushroom button with key Press by hand, the key releases		Y02
P4	Operation head of button with key May lock in the initial position; May take out the key in the initial position		Y12
	Operation head of switch 	0 Self-reset, II Self-reset	
			K42 S42
0 Self-lock, II Self-lock			K51 S51
			K52 S52
0 + I Self-lock			K61 S61
			K62 S62
0 Self-lock, I Self-reset			K81 S81
			K82 S82
K□	Operation head of 4-pole switch		H11
			H12
S□ H□	L Signal lamp Red Green Yellow Blue White		LR LG LY LB LW
L□	Operation head of signal lamp with button Red Green Yellow Blue White		PR
P□			PG
			PY
			PB
			PW



## COMPONENTI Ex-de COMPONENTS Ex-de

	Description	Direction of Anchor Point	Order No.
DW □ 	Operation head of potentiometer setting		DW1
			DW2
B1 	Stopping plug: Seal the unused aperture on the front panel.		B1
EXM 	Calotte: Protective window for measuring meter		EXM

### ADV0201 Series explosion-proof switch module

#### Explosion-proof 2-pole switch module



Switch contact	Order No.
1NC/1NO	0201-□0
2NC	0201-□1
2NO	0201-□2
6 - Board front type	
7 - Board back type	
9 - Board back unit type	

#### Explosion-proof 4-pole switch module

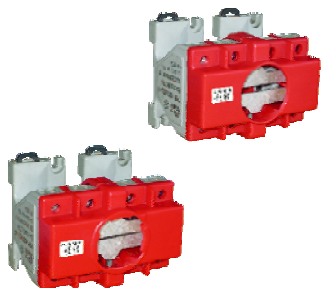

Switch contact	Order No.
2NC/2NO	0201-□50
4NC	0201-□51
4NO	0201-□52
1NC/3NO	0201-□53
3NC/1NO	0201-□54
6 - Board front type	
7 - Board back type	

#### Explosion-proof 4-pole switch module



Contact schematic for operating position	Order No.
See page A / 27 contact schematic	0201-H□ □□□□
6 - Board front type	
7 - Board back type	
Code of switch contact schematic	



## COMPONENTI Ex-de COMPONENTS Ex-de

### ADV0205 series, Ammeter

Ex mark:  $\text{Ex II 2G}$  Ex ell

Intended use: Can be used in zone 1 and zone 2

Ambient temperature use:  $-40^{\circ}\text{C} \leq T_a \leq 60^{\circ}\text{C}$

Ammeter framework: Electromagnetic

Accuracy class: 1.5

Overload scale: 2 times, 5 times

Board front type mounting: May be held on mounting rails

TS35 7.5 or with screws

Board back type mounting: On 1-6mm panel

Meet the standard: IEC60079 EN60079

Conformity to:  $\text{CE}$  0575



Board front type



Board back type



EXM Calotte

Calotte	Measuring way	Overload scale	Measuring range	Order No.(Code)
EXM		2	0-1 / 2A 0-4 / 8A 0-5 / 10A 0-10 / 20A 0-15 / 30A	M□DA 1 M□DA 4 M□DA 5 M□DA 10 M□DA 15
		2	0-1 / 2A 0-2.5 / 5A 0-5 / 10A 0-15 / 30A 0-25 / 50A 0-40 / 80A 0-50 / 100A 0-60 / 120A 0-75 / 150A 0-100 / 200A 0-150 / 300A 0-200 / 400A 0-250 / 500A 0-300 / 600A 0-400 / 800A 0-500 / 1000A 0-600 / 1200A	M□WA 01 / □-2 M□WA 2.5 / □-2 M□WA 5 / □-2 M□WA 15 / □-2 M□WA 25 / □-2 M□WA 40 / □-2 M□WA 50 / □-2 M□WA 60 / □-2 M□WA 75 / □-2 M□WA 100 / □-2 M□WA 150 / □-2 M□WA 200 / □-2 M□WA 250 / □-2 M□WA 300 / □-2 M□WA 400 / □-2 M□WA 500 / □-2 M□WA 600 / □-2
		5	0-1 / 5A 0-2.5 / 12.5A 0-5 / 25A 0-15 / 75A 0-25 / 125A 0-40 / 200A 0-50 / 250A 0-60 / 300A 0-75 / 375A 0-100 / 500A 0-150 / 750A 0-200 / 1000A 0-250 / 1250A 0-300 / 1500A 0-400 / 2000A 0-500 / 2500A 0-600 / 3000A	M□WA 01 / □-5 M□WA 2.5 / □-5 M□WA 5 / □-5 M□WA 15 / □-5 M□WA 25 / □-5 M□WA 40 / □-5 M□WA 50 / □-5 M□WA 60 / □-5 M□WA 75 / □-5 M□WA 100 / □-5 M□WA 150 / □-5 M□WA 200 / □-5 M□WA 250 / □-5 M□WA 300 / □-5 M□WA 400 / □-5 M□WA 500 / □-5 M□WA 600 / □-5

6 — Board front type

7 — Board back type

Connect to the secondary current transformer

5A   
1A